



## ACCESSORY SETUP INSTRUCTION

### FlexGrip, Pair -- PN 852114-00001

VALID FOR: All CFMOTO Vehicles with CFConnect holes

**BEFORE YOU BEGIN:** Read and understand the instructions before starting any work. Make sure that all parts are ready and that you have all the tools required for assembly.

**NOTE:** CFMOTO shall not be liable for any damage caused by incorrect assembly. CFMOTO recommends that all original accessories be assembled by an authorized CFMOTO dealer.

Before assembly, park the vehicle on a flat surface, put the transmission gear into Park (P) and turn off the key switch.

**Zhejiang CFMOTO Power Co., Ltd.** All rights reserved. Reproduction of this document, even in part, as well as copying of all kinds, is permitted only with the express written permission of the copyright owner.

### MEANING OF SYMBOLS



- Indicates information with more details or tips.



- Indicates information of warning or danger.

### PARTS LIST:

ITEM	PART NAME	PART NUMBER	QTY.	REMARK
1	FlexGrip, Pair	852114-00001	1	
2	FlexGrip		2	
3	Rubber Loop		2	
4	CFConnect base		2	
5	Lock Knob		2	

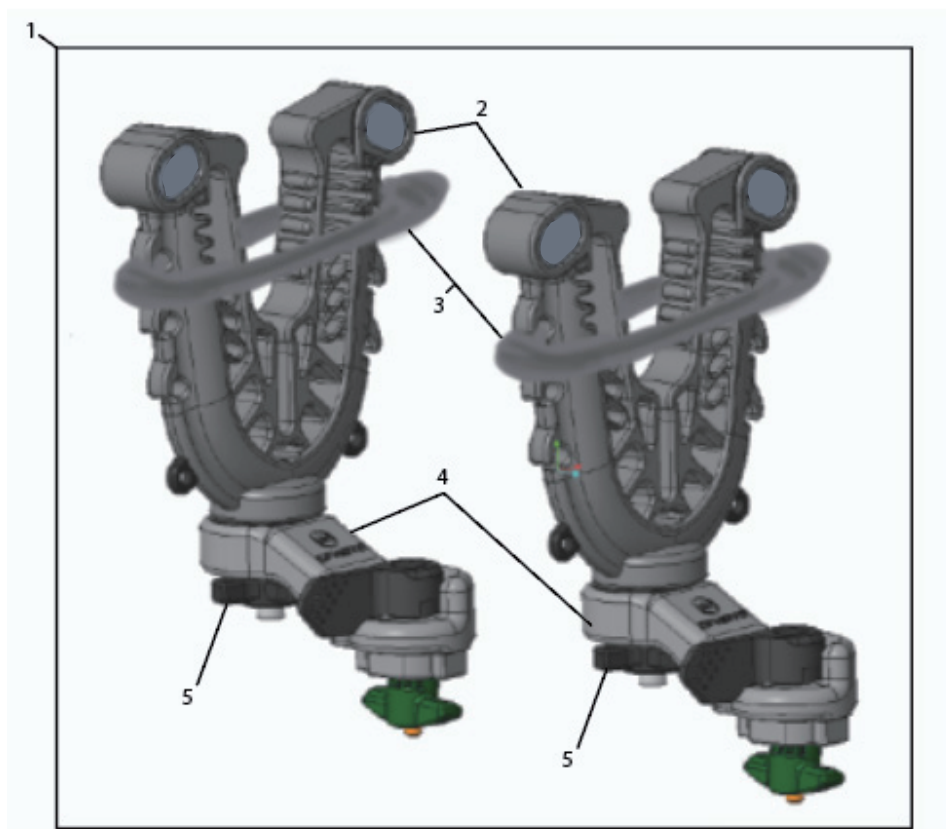

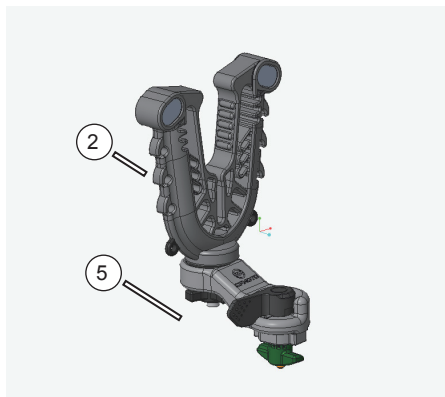

// Loosen Lock Knob (5) and rotate FlexGrip (2) to the desired angle, Tighten Lock Knob (5)

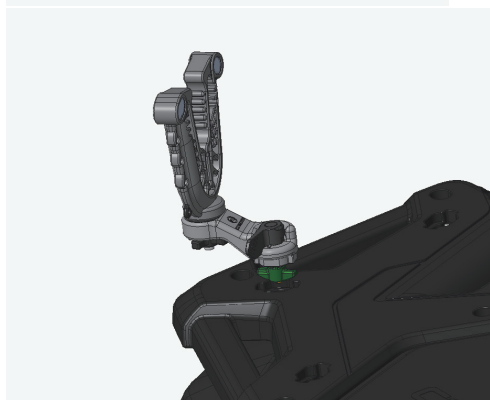

// Insert the FlexGrip assembly (1) into the CFConnect hole

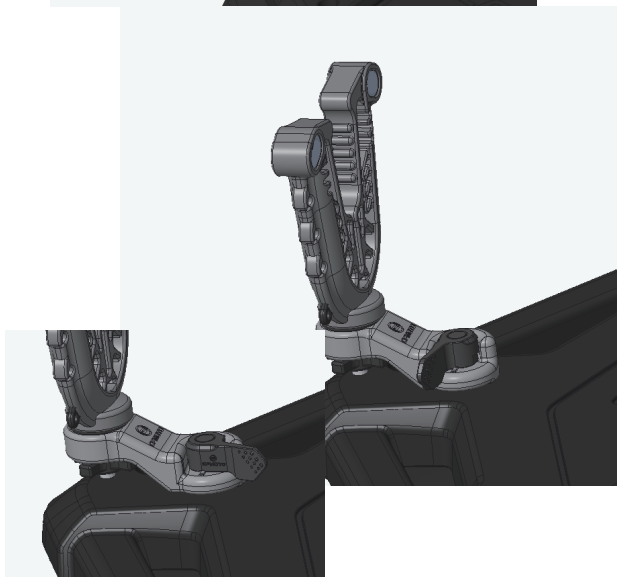

// Rotate the CFConnect lever counterclockwise until locked

// Pull strap over implement to ensure it is secured



// NOTE: always use the provided rubber latch to ensure implements remain attached